

BGC

Fibre Cement

Note: Inter-story junctions in claddings over drained cavities shall be formed for walls to limit cavities to maximum 2 stories or 7m in height in accordance with NZBC acceptable solution E2/AS1 Paragraph 9.1.9.4

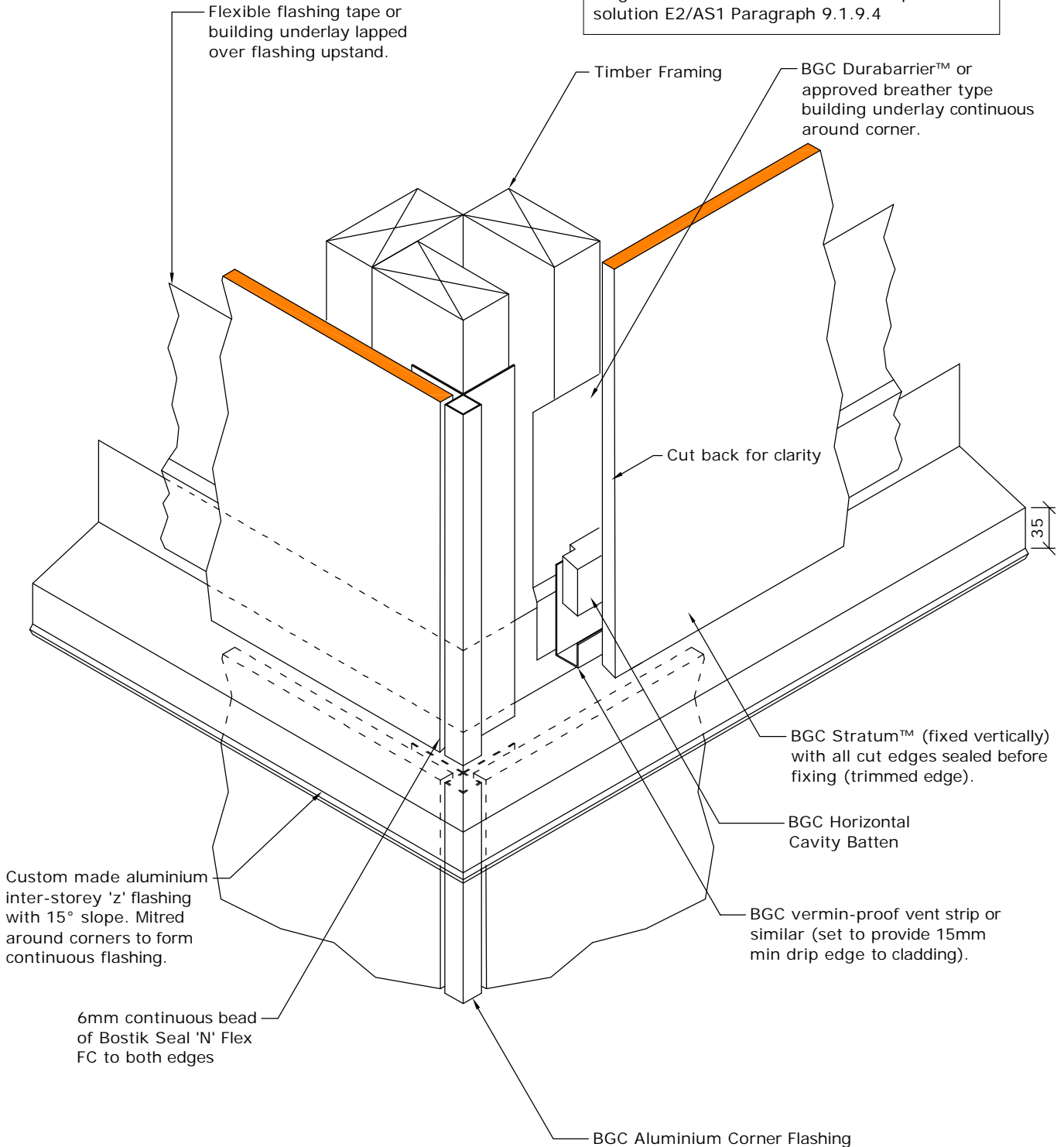

PROFILE

**BGC Stratum™ and Stratum™ Duo
(Vertical Installation)**

DATE Oct 2019

SCALE 1:5 @ A4

DETAIL

Inter-Storey Drainage - External Corner

DETAIL NO. **SVB-09a**