

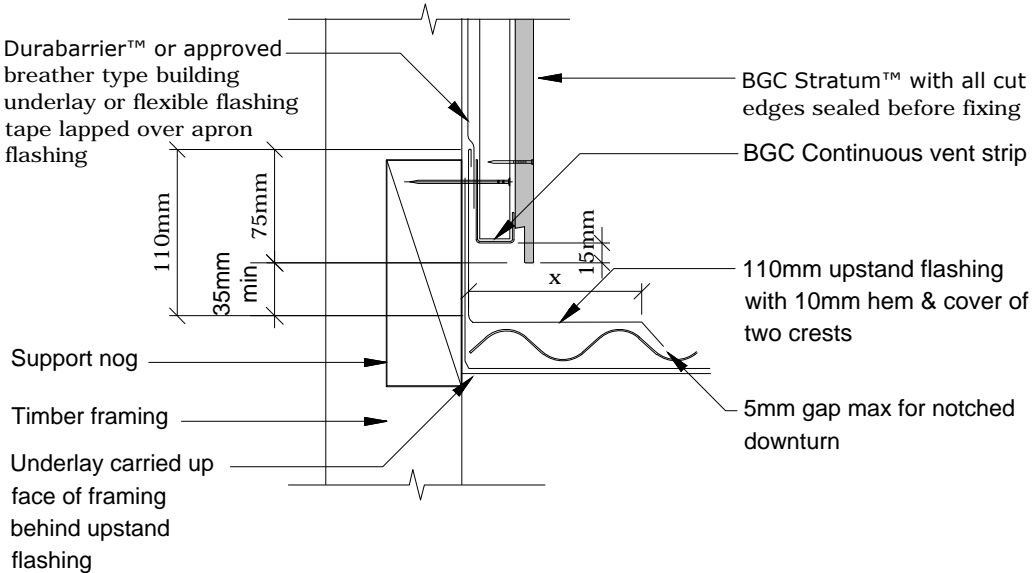

Fibre Cement

Cavity Batten Note:
Refer to cavity batten layout for batten sizes, types, spacing's & fixings

Cladding fixing note:
Refer to cladding fixing layout for all fixing types & spacing's



Note:
x = Refer to NZBC E2 / AS1 Table for flashing cover requirements

PROFILE **BGC Stratum™ and Stratum™ Duo**

DATE **Jan 2014**

DETAIL **Parallel Apron Flashing Detail
Cavity Construction**

SCALE **1:5 @ A4**

DETAIL NO. **ST-29**