

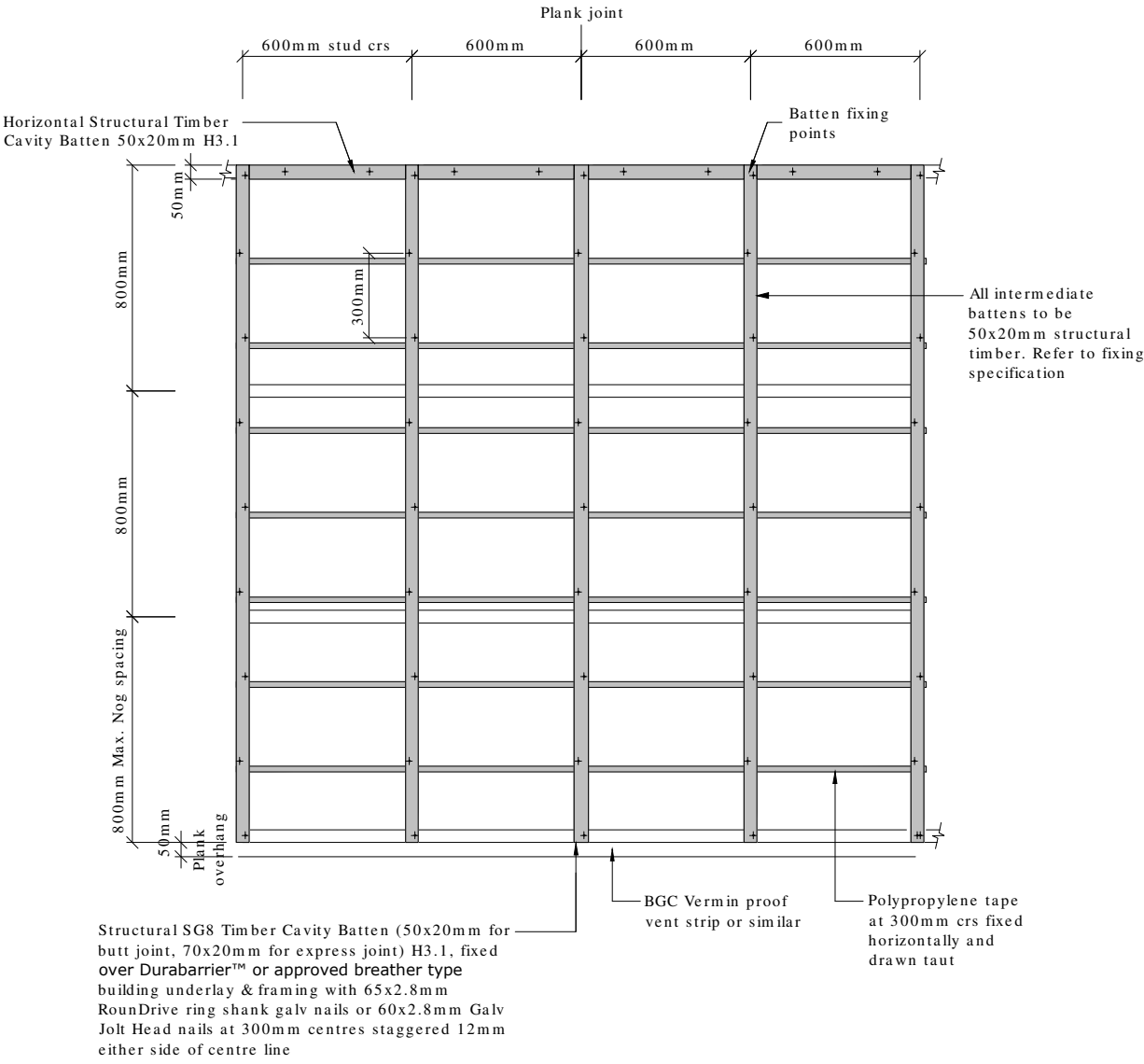

Fibre Cement



BGC Stratum™ Batten Fixing setout

Note:
No horizontal Structural timber Cavity battens required at nogs

PROFILE **BGC Stratum™ and Stratum™ Duo**

DETAIL **Batten Fixing Setout**

DATE Jan 2014

SCALE 1:25 @ A4

DETAIL NO. **ST-01**