

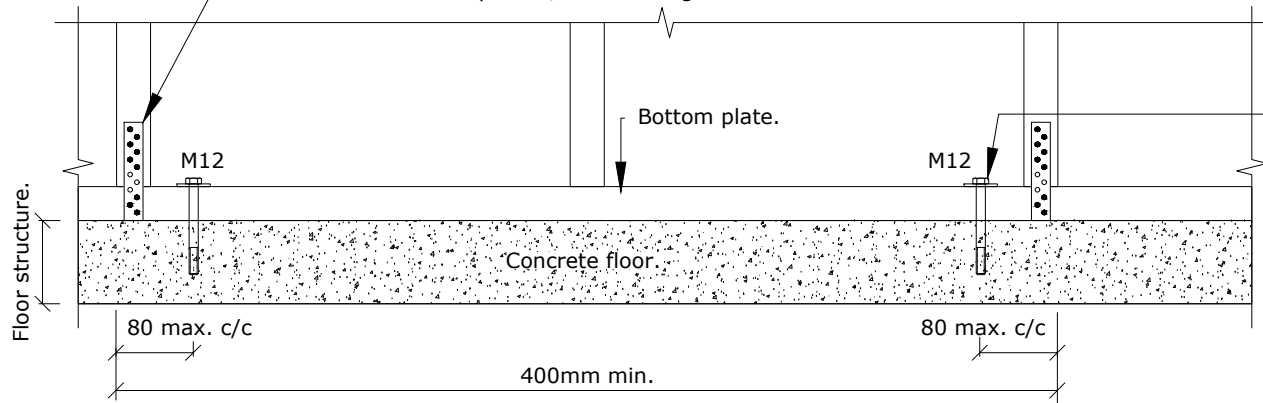

Fibre Cement

BGC - B1 / B2 / B3 / B5
 Secure end studs (each end of bracing element) to bottom plate with 400x25x1.0mm galvanised mild steel strap, fixed each side of stud with 6/30x2.5mm galvanised flat head nails, and to each side of bottom plate 3/30x2.5mm galvanised flat head nails.



Bottom plate hold down (concrete floor) M12x150mm HD galvanised bolts cast-in, 80mm max from end stud with 50x50x3.0mm square HD galvanised washer, or proprietary anchors with a minimum characteristic uplift strength of 15kN each end. Intermediate fixings as per NZS 3604:2011

Brace Panel Hold Down - Construction Detail BGC 4.5mm Durabarrier™ - B1 / B2 / B3 / B5 (400mm min.) Concrete Floor - Straps

Intermediate fixings as per NZS 3604:2011

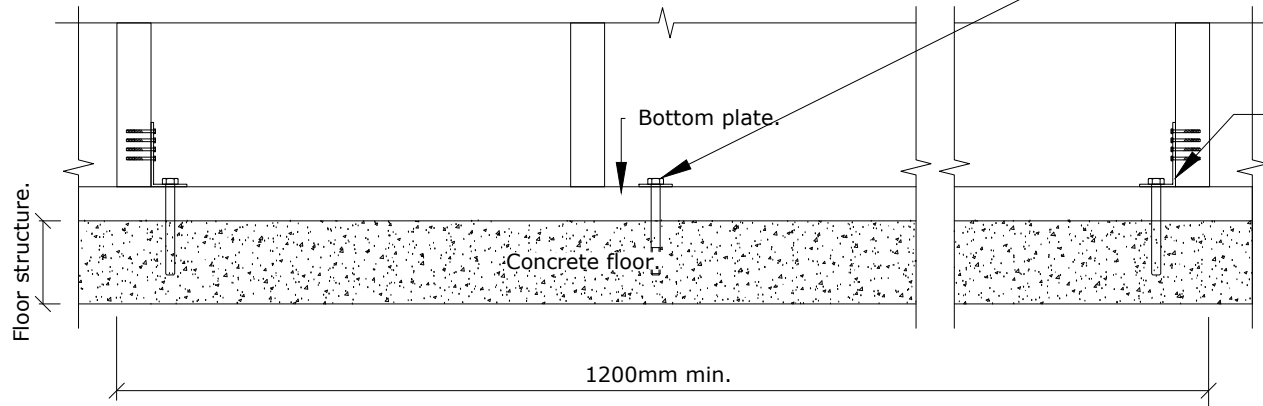

Secure end studs (at sheet sides) to concrete slab with GIB handibrac installed as per GIB specification

Brace Panel Hold Down - Construction Detail BGC 6mm / 4.5mm Durabarrier™ - B4 / B6 / B20 / B21 / B22 (1200mm min.) Concrete Floor - Handibrac

PROFILE BGC Durabarrier™ 4.5mm / 6mm

DATE Aug 2018

DETAIL Concrete Floor - Brace Element (Hold Down)

SCALE 1:10 @ A4

DETAIL NO. DB10